

FIRE-RATED ENTRY DOOR OPTIONS

Note: Fire-rated doors are not Energy Star certified products. Fire-Rated French Doors are not available.

Fire-Rated Door Packages:

Any opaque (non-glass) 20-Gauge Smooth or Woodgrain Textured Steel Full Wood Frame Single Entry Doors meeting the following criteria can be upgraded to be a 20-minute or 90-minute Fire Labeled unit. PermaTech Composite Frames are also available with a 20-minute fire label.

Signet Full Wood Frame 006 & 002C449 Single Entry Doors meeting the following criteria can be upgraded to be a 20-minute Fire Labeled unit.

Steel Door with Full Wood Frame 20-Minute Fire-rated Package:

Standard Sizes: Standard sizes are listed by door styles.
 Frame: Full Wood or PermaTech™ Composite Frame.
 Custom Heights and Widths are available. (See page 115 for more information)
 Maximum size available is 36" x 84".
 20-minute fire-label on the door slab and frame.
 Fire-rated Q-lon weatherstripping.
 2 Spring Bommer hinges.
 Standard Sahara™ threshold or ADA sill.

006 & 002C-449 Signet® Fiberglass Door with Full Wood Frame 20-Minute Fire-rated Package:

Slab Construction: Special medium-density solid core for a 20-minute fire-rating. Signet Fire-Rated Doors are not Energy Star® certified.
 Standard Sizes: Standard sizes are listed by door styles.
 Frame: Full Wood or PermaTech Composite Frame.
 Custom Heights between 80" and 84" and Custom Widths between 32" and 36" are available.
 Maximum size available is 36" x 84".
 20-minute fire-label on the door slab and frame.
 Fire-rated Q-lon weatherstripping.
 2 Spring Bommer hinges.
 Standard Sahara threshold or ADA sill.

Signet fire-rated doors require 6 week lead time.

Redi-Flex Adjustable Steel Frame 90-Minute Fire-rated Package:

Standard Sizes: 32" & 36" x 80".
 Custom Heights are available on 20-Gauge doors with a bottom cut only. (See page 115 for maximum height reduction information)
 Custom Widths are not available.
 90-minute fire-label on the door slab and frame.
 Fire-rated Q-lon weatherstripping.
 2 Spring Bommer hinges.
 Standard Sahara threshold or ADA sill.

Masonry Steel Weatherstrip Frame 90-Minute Fire-rated Package:

Standard Sizes: 30", 32", 34" & 36" x 80" & 84" (not all door styles available in all sizes).
 Custom Heights are available on 20-Gauge doors with a bottom cut only. (See page 115 for maximum height reduction information)
 Custom Widths are not available.
 90-minute fire-label on the door slab and frame.
 Fire-rated Q-lon weatherstripping.
 2 Spring Bommer hinges.
 Saddle threshold or no threshold.

Drywall Steel Weatherstrip Frame 90-Minute Fire-rated Package:

Standard Sizes: 30", 32" & 36" x 80" (not all door styles available in all sizes).
 Custom Heights are available on 20-Gauge doors with a bottom cut only. (See page 115 for maximum height reduction information)
 Custom Widths are not available.
 90-minute fire-label on the door slab and frame.
 Fire-rated Q-lon weatherstripping.
 2 Spring Bommer hinges.
 Saddle threshold or no threshold.

Fire-rated Package Upcharge Pricing Instructions:

- 1: Find the Full Wood Frame Standard Package price of one of the door styles listed above in the Criteria section.
- 2: Deduct \$ from the Standard Package price to get down to a basic unfinished door without hardware.
- 3: Add one of the Fire-Rated Package Upcharges listed below.
- 4: If you want a Fire-Rated lockset and/or deadbolt add these from the list below.
- 5: If you want a painted or stained door add a paint finish charge from page 115. See next page for frame paint finish charges for the steel fire-rated frames.
- 6: Other options such as a 7/8" peepsite, frame extensions, frame cladding, etc... can be added.
- 7: Some options that are not available on fire-rated doors include a Speakeasy and Mail or Magazine Slots.

Fire-rated Schlage F51F Locksets: (these locksets meet the NFPA specifications required on fire-rated doors)

Georgian Knob - 10-Year Finish - Bright or Antique Brass.....	\$
Accent Lever - 10-Year Finish - Bright or Antique Brass	\$
Georgian Knob - Lifetime Finish - Bright Brass, Satin Nickel or Aged Bronze	\$
Accent Lever - Lifetime Finish - Bright Brass, Satin Nickel or Aged Bronze.....	\$

Fire-rated Schlage B360F Deadbolts: (these deadbolts meet the NFPA specifications required on fire-rated doors)

Thumbturn deadbolt - 10-Year Finish - Bright or Antique Brass.....	\$
Thumbturn deadbolt - Lifetime Finish - Bright Brass, Satin Nickel or Aged Bronze	\$

20-Minute Fire-rated Package Upcharge (Full Wood or Perma-Tech Composite Frame):

Steel Door - Single Door with no hardware (lockset prep only) ¹²	\$
Signet Fiberglass Door - Single Door with no hardware (lockset prep only) ¹²	\$

90-Minute Fire-rated Package Upcharge:

RediFlex Adjustable Steel Frame Single Door with no hardware (lockset prep only)*	\$
Masonry Steel Weatherstrip Frame Single Door with no hardware (lockset prep only)*	\$
Drywall Steel Weatherstrip Frame Single Door with no hardware (lockset prep only)*	\$

ENTRY DOOR SPECIALTY STEEL FRAMES

When ordering, specify frame type: RediFlex Adjustable, Masonry or Drywall and options desired (threshold, anchors).

Note: When pricing find door design under the Full Wood Frame price, then add steel frame package upcharge and options.

RediFlex® Adjustable Steel Frame:

2 piece adjustable depth steel L-frame for wall depths from:

- 4½" to 5½"
- 5½" to 6½"
- 6½" to 7½"

Includes a Sahara threshold.
Optional ADA & Saddle threshold also available.

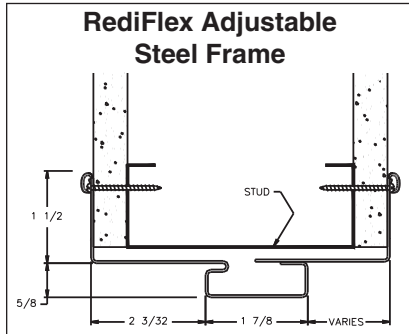

RediFlex Adjustable Steel Frame Packages:

	Price
Single 32" & 36" x 80".....	\$

Masonry Steel Weatherstrip Frame Packages:(recommended for exterior applications)

Single 30", 32", 34", 36", 42" x 80", 84".....	\$
French 60", 64", 72" x 80", 84".....	\$

Drywall Steel Weatherstrip Frame Packages:(recommended for interior applications)

Single 30", 32", 36", 42" x 80".....	\$
French 60", 64", 72" x 80".....	\$

Saddle Threshold (not available with Full Wood & Composite Frames)

Single	\$
French	\$

Anchors (not applicable on RediFlex Steel Frame)

Masonry or Wood Stud Anchors.....	Each \$
(6 recommended per frame)	

Masonry & Drywall Steel Frame:

5¼" jamb depth
4¾" throat
18-gauge steel
Includes ADA Saddle Threshold

	Existing Opening Anchors	Each \$
(4 recommended per frame)		

	Metal Stud Anchors	Each \$
(6 recommended per frame)		

Steel Frame Painted to Match Door

Single.....	\$
French.....	\$

See the Fire-Rated Door Options section for pricing on Steel Frames with a 90-minute Fire Label.

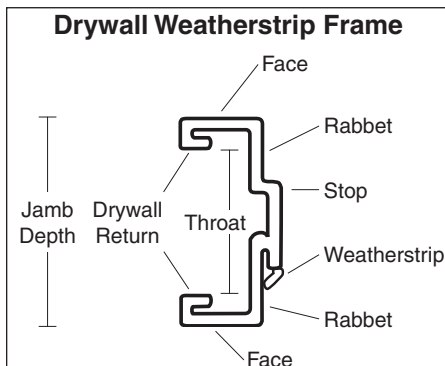
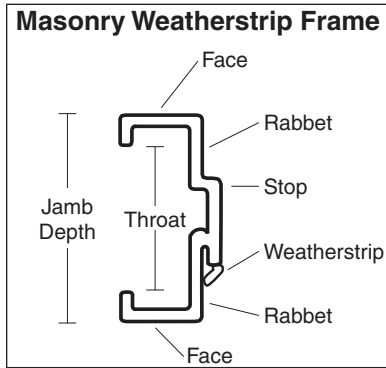

Note: Fire-rated doors or doors with Specialty Steel Frames are not Energy Star certified products.

Steel Frame Sizes			
Nominal Door Width	Rough Opening Width		
	Drywall	Masonry	RediFlex
30"	31½"	34⅞"	N/A
32"	33½"	36⅞"	33"
34"	N/A	38⅞"	N/A
36"	37½"	40⅞"	37"
42"	43½"	46⅞"	N/A
60"	62"	64⅞"	N/A
64"	66"	68⅞"	N/A
72"	74"	76⅞"	N/A
Nominal Door Height	Rough Opening Height		
	Drywall	Masonry	RediFlex
80"	80¾"	82¼"	81⅞"
84"	N/A	86¼"	N/A

ENTRY DOOR MEASURING AND ORDERING INFORMATION

Sizing Information

Standard Sizes

The sizes (sometimes called nominal sizes) listed in this price list by each style are the Standard Sizes that are available for that particular door style. To order a Standard Size door simply check the appropriate Standard Size width and height box in the Standard Sizes section of the order form. Remember, not all styles are available in all the sizes that are listed on the order form. Check the price list for the Standard Size availability for a particular door style and type.

Custom Sizes

All doors and sidelites can be cutdown to a custom height. In some cases, based on the amount of cutdown needed the unit may need to be cutdown from the top and the bottom. See page 115 for pricing and maximum cutdown information. Doors with sidelites can have a custom size width by increasing the size of the mullion between the door and each sidelite. See page 125 for mullion build-up pricing. Custom widths are available for Legacy 20-Gauge Smooth & Textured Steel and Signet Fiberglass doors. See page 115 for pricing and size chart.

Sizing Chart

Standard Sizes: Use the Sizing Charts on the next two pages to determine what Opening Size or Rough Opening you will need for any of the Standard Size doors that are listed in the price list. This chart also shows the Unit Size and Brickmold to Brickmold Size.

Custom Sizes: If you measure your door using one of the methods listed below you can use the Sizing Charts on the next two pages to determine if you need a Standard Size or a Custom Size door.

Measuring Instructions

A Frame Rabbet Opening Size

Use Frame Rabbet Opening Size measurements when there is an existing wood frame in the opening. Frame Rabbet Opening Size is the simplest way to measure a door since there is no need to remove any existing interior trim. Frame Rabbet Opening Size measurements can be used to order Full Wood Frame or Steel L-frame doors. When using Frame Rabbet Opening Size to order a door be sure to check the Frame Rabbet Opening Size box on the Order Form.

Frame Rabbet Opening Size Width: To measure the Frame Rabbet Opening Size width measure between the left and right frame rabbet at the top, middle and the bottom. Use the smallest dimension.

Frame Rabbet Opening Size Height: To measure the Frame Rabbet Opening Size height measure from the bottom of the threshold to the bottom of top frame rabbet.

Note: Frame Rabbet Opening Size and Rough Opening are **not** the same measurement. See below for an explanation of Rough Opening.

B Unit Size

Use the Unit Size measurement to specify the exact size of a Full Wood Frame (not including brickmold). Use Unit Size measurements if the Full Wood Frame size of a new door needs to match the existing door's wood frame size. Unit Size measurements are used only for Full Wood Frame doors. Do not order Steel L-frame doors using Unit Size measurements. When using Unit Size to order a door be sure to check the Unit Size box on the Order Form.

Unit Size Width: To measure the Unit Size width measure the actual width of the existing door's wood frame (not including brickmold) at the top, middle and the bottom. Use the smallest dimension.

Unit Size Height: To measure the Unit Size height measure from the bottom of the threshold to the top of the existing door's frame (not including brickmold).

Note: To measure the Unit Size of an existing door's wood frame the existing interior trim (if any) will need to be removed.

C Rough Opening Size

Use Rough Opening measurements for New Construction type openings. Rough Opening can also be used to measure an existing door if the interior trim is removed and the wall studs are exposed. Rough Opening measurements are used only for Full Wood Frame doors. Do not order Steel L-frame doors using Rough Opening measurements. When using Rough Opening to order a door be sure to check the Rough Opening box on the Order Form.

Rough Opening Width: To measure the Rough Opening width measure between the left and right vertical wall studs that are framing the opening.

Rough Opening Height: To measure the Rough Opening height measure from the floor to the bottom of the top header framing the opening.

Note: To measure the Rough Opening of an existing door the interior trim (if any) will need to be removed.

D Brickmold to Brickmold Size

Use the Brickmold to Brickmold Size measurement to specify the exact size of a Full Wood Frame including brickmold. Use Brickmold to Brickmold Size measurements if the brickmold size of a new door needs to match the existing door's brickmold size. Brickmold to Brickmold Size measurements are used only for Full Wood Frame doors. Do not order Steel L-frame doors using Brickmold to Brickmold Size measurements. When using Brickmold to Brickmold Size to order a door be sure to check the Brickmold to Brickmold Size box on the Order Form.

Brickmold to Brickmold Size Width: To measure the Brickmold to Brickmold Size width measure the actual width of the existing door's brickmold at the top, middle and the bottom. Use the smallest dimension.

Brickmold to Brickmold Size Height: To measure the Brickmold to Brickmold Size height measure from the bottom of the threshold to the top of the existing door's brickmold.

Note: When ordering custom size doors using Brickmold to Brickmold Size please note that we will cut down the door and the wood frame to achieve the custom Brickmold to Brickmold Size. To accommodate standard size Rough Openings with custom Brickmold to Brickmold Sizes the brickmold itself can be custom sized and/or shipped loose.

Handing Instructions

See the figures below to determine the handing of your entry door. Inswing doors are viewed from the inside & Outswing doors are viewed from the outside.

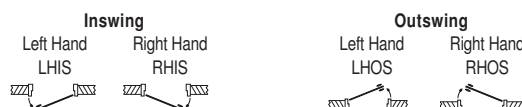

ENTRY DOOR SIZING INFORMATION

Ⓐ Frame Rabbet Opening Size:

Frame Rabbet Opening Width is the dimension from inside frame rabbet to inside frame rabbet.

Frame Rabbet Opening Height is the dimension from the bottom of the threshold to the bottom of the top frame rabbet

Ⓑ Full Wood Frame Unit Size:

Unit Width is the total width of the door frame not including the brickmold.

Unit Height is the dimension from the bottom of the threshold to the top of the door frame not including the brickmold.

Ⓒ Rough Opening Size:

Rough Opening Width is the dimension between the 2 wall studs framing the opening.

Rough Opening Height is the dimension from the floor to the bottom of the header framing the opening.

Ⓓ Brickmold to Brickmold Size:

Brickmold to Brickmold Width is the total width of the brickmold.

Brickmold to Brickmold Height is the dimension from the bottom of the threshold to the top of the brickmold.

Ⓔ Steel L-Frame Frame Unit Size:

Unit Width is the total width of the door frame not including the inside flange.

Unit Height is the dimension from the bottom of the threshold to the top of the door frame not including the inside flange.

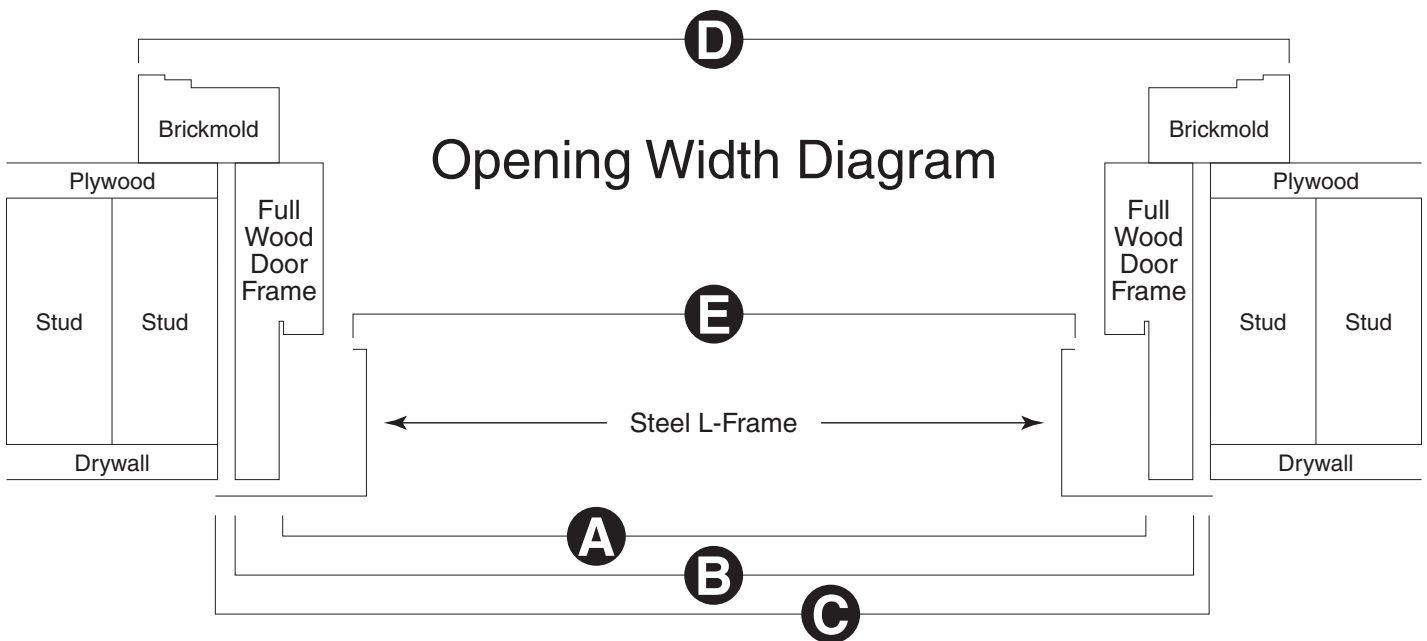
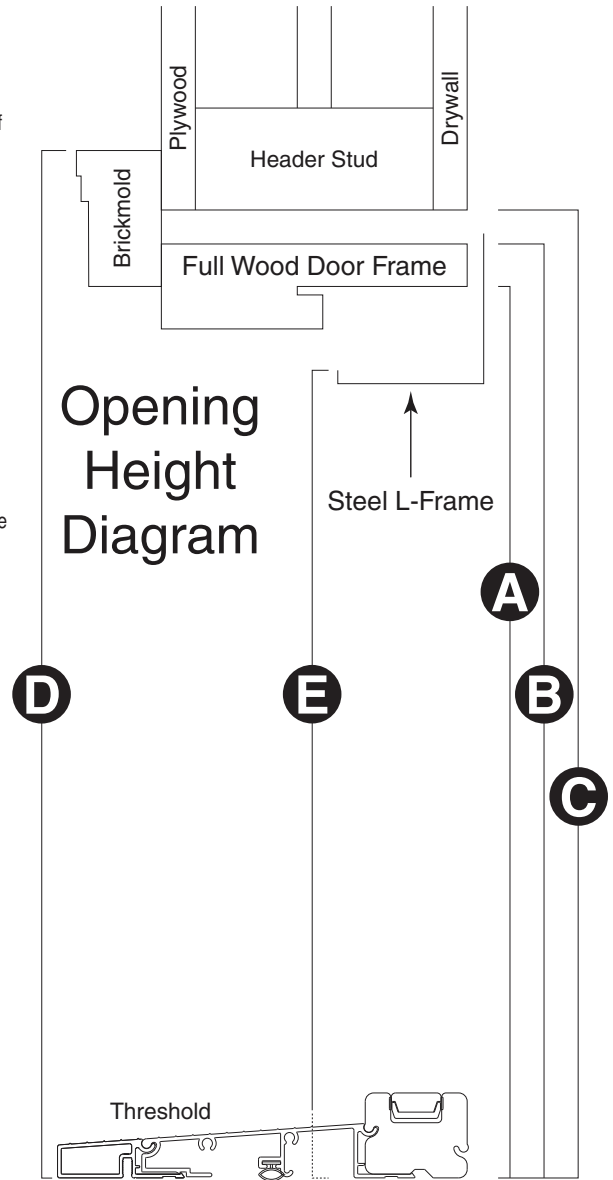

ENTRY DOOR SIZING INFORMATION

DOOR AND SIDELITE UNITS WITH FRAME DEPTH GREATER THAN 6 7/16"

On Full Wood Frame Doors with Sidelites that have a frame depth greater than 6 7/16" you must now choose one of the following build-up options.

Perimeter & Mullion Build-up:

See Figure A to see how both the perimeter wood frame and the center mullions are extended the same distance.

Perimeter Only Build-up:

See Figure B to see how only the perimeter wood frame is extended to the desired frame depth. The center mullions are only extended to a 5 1/4" frame depth regardless of the perimeter frame depth.

Figure A

Perimeter & Mullion Build-up

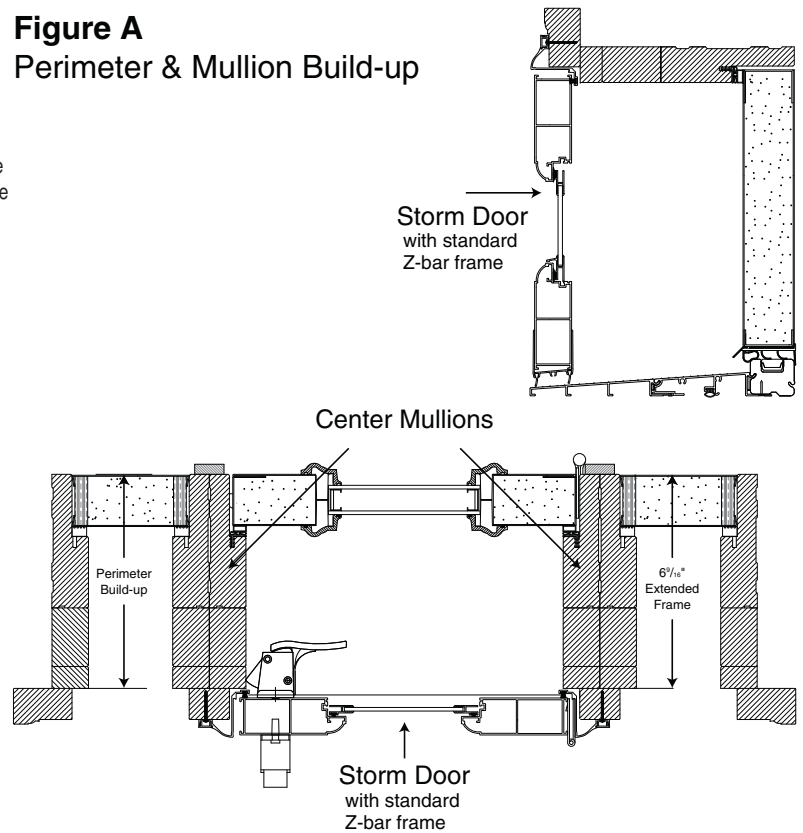
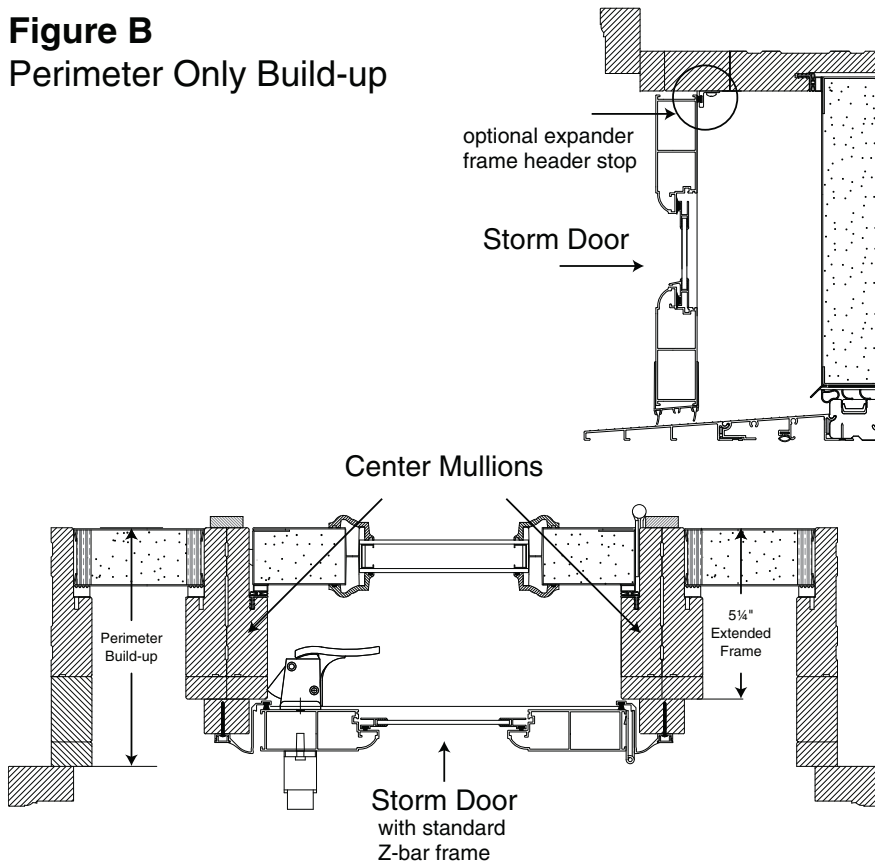

Figure B

Perimeter Only Build-up



ENTRY DOOR SIZING INFORMATION

Full Wood Frame Sizes

Height Measurements

Nominal ¹³	Frame Rabbet Opening Size	Unit Size	Rough Opening	Brickmold to Brickmold
Patio Units (Downsized)				
80"	78 1/2"	79 3/8"	79 7/8"	80 5/8"
Patio Units (Fullsized)				
80"	80 3/4"	81 5/8"	82"	82 7/8"
All Full Wood Frame Doors				
80"	80 3/4"	81 5/8"	82"	82 7/8"
84"	84 3/4"	85 5/8"	86"	86 7/8"
96"	96 3/4"	97 5/8"	98"	98 7/8"
All Full Wood Frame Doors with 612, 613 or 616 Transoms				
80"	96"	97 1/16"	97 9/16"	98 5/16"
84"	100"	101 1/16"	101 9/16"	102 5/16"

Note: Units with 612/613TUS transoms are 1/2" wider than sizes shown.

Nominal ¹³	Frame Rabbet Opening Size	Unit Size	Rough Opening	Brickmold to Brickmold
All Full Wood Frame Doors with 512, 513, 712 or 713 Transoms				
80"	96"	96 7/8"	97 3/8"	98 1/8"
84"	100"	100 7/8"	101 3/8"	102 1/8"
All Full Wood Frame Doors with 516 Transoms				
80"	99 3/8"	100 7/16"	100 15/16"	101 11/16"
84"	103 3/8"	104 7/16"	104 15/16"	105 11/16"
All Full Wood Frame Doors with 532 Transoms				
80"	114 5/8"	115 11/16"	116 3/16"	116 15/16"
84"	118 5/8"	119 11/16"	119 3/16"	120 15/16"

- To calculate the Unit Size Height for Full Wood Frame Outswing doors, deduct 7/8" from the sizes shown above.
- To calculate the Brickmold to Brickmold Height for Full Wood Frame Outswing doors, deduct 5/8" from the sizes shown above.

Width Measurements

Nominal ¹³	Frame Rabbet Opening Size	Unit Size	Rough Opening	Brickmold to Brickmold
Single Door				
24"	24 1/16"	25 9/16"	26"	28 1/16"
28"	28 1/16"	29 9/16"	30"	32 1/16"
30"	30 1/16"	31 9/16"	32"	34 1/16"
32"	32 1/16"	33 9/16"	34"	36 1/16"
34"	34 1/16"	35 9/16"	36"	38 1/16"
36"	36 1/16"	37 9/16"	38"	40 1/16"
42"	42 1/16"	43 9/16"	44"	46 1/16"
French Door				
48"	48 5/8"	50 1/8"	50 7/8"	52 5/8"
56"	56 5/8"	58 1/8"	58 7/8"	60 5/8"
60"	60 5/8"	62 1/8"	62 7/8"	64 5/8"
64"	64 5/8"	66 1/8"	66 7/8"	68 5/8"
68"	68 5/8"	70 1/8"	70 7/8"	72 5/8"
72"	72 5/8"	74 1/8"	74 7/8"	76 5/8"
84"	84 5/8"	86 1/8"	86 7/8"	88 5/8"

Width Measurements

Nominal ¹³	Frame Rabbet Opening Size	Unit Size	Rough Opening	Brickmold to Brickmold
Single Door w/1 12" Sidelite				
30"	43 5/16"	44 13/16"	45 9/16"	47 5/16"
32"	45 5/16"	46 13/16"	47 9/16"	49 5/16"
34"	47 5/16"	48 13/16"	49 9/16"	51 5/16"
36"	49 5/16"	50 13/16"	51 9/16"	53 5/16"
Single Door w/1 14" Sidelite				
30"	45 5/16"	46 13/16"	47 9/16"	49 5/16"
32"	47 5/16"	48 13/16"	49 9/16"	51 5/16"
34"	49 5/16"	50 13/16"	51 9/16"	53 5/16"
36"	51 5/16"	52 13/16"	53 9/16"	55 5/16"
Single Door w/2 12" Sidelites				
30"	56 9/16"	58 1/16"	58 13/16"	60 9/16"
32"	58 9/16"	60 1/16"	60 13/16"	62 9/16"
34"	60 9/16"	62 1/16"	62 13/16"	64 9/16"
36"	62 9/16"	64 1/16"	64 13/16"	66 9/16"
Single Door w/2 14" Sidelites				
30"	60 9/16"	62 1/16"	62 13/16"	64 9/16"
32"	62 9/16"	64 1/16"	64 13/16"	66 9/16"
34"	64 9/16"	66 1/16"	66 13/16"	68 9/16"
36"	66 9/16"	68 1/16"	68 13/16"	70 9/16"
Patio Units - Downsized (Standard Height = downsized height)				
60"	57 15/16"	59 7/16"	60 3/16"	61 15/16"
64"	61 15/16"	63 7/16"	64 3/16"	65 15/16"
68"	65 15/16"	67 7/16"	68 3/16"	69 15/16"
72"	69 15/16"	71 7/16"	72 3/16"	73 15/16"
90"	87 1/16"	88 9/16"	89 5/16"	91 1/16"
96"	93 1/16"	94 9/16"	95 5/16"	97 1/16"
102"	99 1/16"	100 9/16"	101 5/16"	103 1/16"
108"	105 1/16"	106 9/16"	107 5/16"	109 1/16"
Patio Units - Fullsized (Standard Height = fullsized height)				
60"	60 1/8"	61 5/8"	62 3/8"	64 1/8"
64"	64 1/8"	65 5/8"	66 3/8"	68 1/8"
68"	68 1/8"	69 5/8"	70 3/8"	72 1/8"
72"	72 1/8"	73 5/8"	74 3/8"	76 1/8"
90"	90 1/4"	91 3/4"	92 1/2"	94 1/4"
96"	96 1/4"	97 3/4"	98 1/2"	100 1/4"
102"	102 1/4"	103 3/4"	104 1/2"	106 1/4"
108"	108 1/4"	109 3/4"	110 1/2"	112 1/4"

- For 10" sidelites, deduct 2" per sidelite from the 12" sidelite dimensions.
- For 16" sidelites, add 2" per sidelite to the 14" sidelite dimensions.
- Optional Aluminum Frame Cladding will increase the Brickmold to Brickmold width by 1/4" and the height by 1/8".
- Sidelite units with PermaTech Composite Frames are wider than the dimensions shown above. Add 1/8" per sidelite.
- The brickmold width on Outswing Doors is 5/8" more than shown.

Steel L-Frame Sizes

Width Measurements

Single Door				French Door ¹⁴			
Nominal ¹³	Frame Rabbet Opening Size Range	Unit Size ¹⁵		Frame Rabbet Opening Size Range	Unit Size ¹⁵		
	Minimum	Maximum		Minimum	Maximum		
24"	23 7/8"	to 24 1/2"	23 1/2"	48"	47 1/8"	to 47 7/8"	46 15/16"
28"	27 7/8"	to 28 1/2"	27 1/2"	56"	55 1/8"	to 55 7/8"	54 15/16"
30"	29 7/8"	to 30 1/2"	29 1/2"	60"	59 1/8"	to 59 7/8"	58 15/16"
32"	31 7/8"	to 32 1/2"	31 1/2"	64"	63 1/8"	to 63 7/8"	62 15/16"
34"	33 7/8"	to 34 1/2"	33 1/2"	68"	67 1/8"	to 67 7/8"	66 15/16"
36"	35 7/8"	to 36 1/2"	35 1/2"	72"	71 1/8"	to 71 7/8"	70 15/16"
42"	41 7/8"	to 42 1/2"	41 1/2"				

Height Measurements

Single Door			
Nominal ¹³	Frame Rabbet Opening Size Range	Unit Size ¹⁵	
	Minimum	Maximum	
78"	77 7/8"	to 78 1/2"	77 13/16"
80"	79 7/8"	to 80 1/2"	79 13/16"
82"	81 7/8"	to 82 1/2"	81 13/16"
84"	83 7/8"	to 84 1/2"	83 13/16"

13 Use the size listed in the Nominal column to order a storm door to fit that entry door.

14 Please note the Frame Rabbet Opening Width Ranges for Steel L-Frame French Doors! For example, the optimal Frame Rabbet Opening Width for a 72" Steel L-Frame French Door is 71 1/4" to 71 1/2". A 72" Frame Rabbet Opening Width will require some shimming.

15 Steel L-Frame unit sizes are for reference purposes only. Use Frame Rabbet Opening Size when ordering Steel L-Frame doors.